



# Газовые термостаты 2

SIT.....	46
MERTIK.....	51
MP_JUNKERS.....	52
PEL.....	52
AB.....	56
COPRECI.....	56
SABAF.....	57
ROBERTSHAW.....	58
TEDDINGTON.....	59
STN3R.....	59

## газовые термостаты

SIT

## 630 Eurosit series



fig.	temp. (°C)	gas inlet	gas outlet	TCC	PC	probe ø (mm)	probe L (mm)	cap. (mm)	Ref. No.
1 107220	13-38	3/8"	3/8"	M9x1	M10x1	8	120	1050	0630001
2 101199	13-38	3/8"	3/8"	M10x1	M10x1	8	120	1050	0630025
3 101413	30-100	3/8"	3/8"	M9x1	M10x1	5	122	1050	0630325
3 101188	110-190	3/8"	3/8"	M9x1	M10x1	4	202	1050	0630332
3 101992	110-190	3/8"	3/8"	M9x1	M10x1	4	202	1050	0630337
3 103076	110-190	3/8"	3/8"	M9x1	M10x1	4	202	1050	0630334
3 107221	40-250	3/8"	3/8"	M9x1	M10x1	4	72	1050	0630335
3 101409	40-280	3/8"	3/8"	M9x1	M10x1	4	72	1050	0630328
3 101696	60-300	3/8"	3/8"	M9x1	M10x1	4	72	1050	0630330
3 101915	80-320	3/8"	3/8"	M9x1	M10x1	4	72	1050	0630327
3 101125	100-340	3/8"	3/8"	M9x1	M10x1	4	72	1050	0630326
3 101700	100-340	3/8"	3/8"	M9x1	M10x1	4	72	1050	0630331
3 106035	100-340	3/8"	3/8"	M9x1	M10x1	4	72	1050	0630336
3 102870	140-340	3/8"	3/8"	M9x1	M10x1	4	72	1050	0630205
4 106164	100-340	3/8"	3/8"	M9x1	M10x1	4	72	1050	0630345
4 107688	100-340	3/8"	3/8"	M9x1	M10x1	4	72	1050	0630349
5 101769	100-340	3/8"	3/8"	M10x1	M10x1	4	72	1050	0630206

## accessories

## spindles and knob adapters



fig.	shaft ø (mm)	shaft L (mm)	suitable for	fig.	shaft ø (mm)	shaft L (mm)	suitable for	fig.	shaft ø (mm)	shaft L (mm)	suitable for
1 101390	6x4.6	32/15	Mareno	2 106810	8x6.5	44/17	Cookmax Olis	6 101712	10x8	19/19	Olis
1 100825	8x6.5	22/14	Angelo-Po	2 106158	8x6.5	23/16	Baron	7 110358	10x8	29/18	Electrolux Zanussi
1 110357	8x6.5	36/12	Baron Cookmax Electrolux Zanussi	2 101600	8x6.5	42/12	Tecnoinox	8 101392			Angelo-Po Baron Cookmax Electrolux Lotus Mareno SIT Zanussi
1 100924	8x6.5	33/15	Lotus	2 106811	8x6.5	48/16	Cookmax Olis				
2 109186	8x6.4	24/12	Fagor	3 113022	8x6.4	13/13	Fagor				
				4 101816	10x8	17/17	Mareno				
				5 106877	10x8	18/18	Electrolux				



miscellaneous

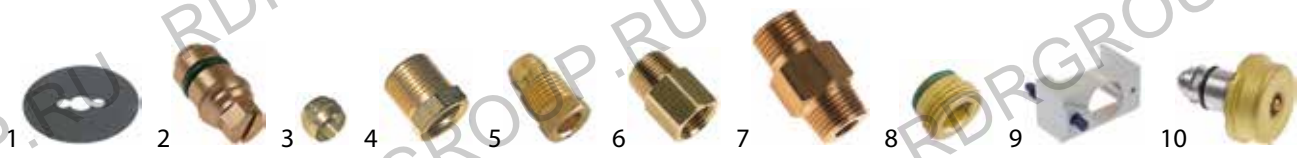

fig.	description		fig.	description	
1	100949	gasket suitable for series 630 Eurosit	5	101602	locking screw thread M10x1 for pipe ø 1/4"
2	106261	adjusting screw M16 for large flame settable	6	106603	screw connection 3/8" tube ø 10mm
3	101273	olive for pipe ø 12mm L 9,5mm brass Qty 1 pcs	7	106604	screw connection 3/8" tube ø 10mm
4	101276	union screw thread 3/8" tube ø 12mm Qty 1 pcs	8	101333	plug 3/8" with O-ring
5	100905	locking screw M10x1 for pipe ø 6mm Qty 1 pcs	9	101358	cover cap for piezoelectric igniter
5	102505	locking screw M10x1 for pipe ø 6mm Qty 5 pcs	10	107565	pressure controller pressure range 3-18mbar
5	100904	locking screw M10x1 for pipe ø 4mm Qty 1 pcs			

710 Minisit series



fig.	temp. (°C)	gas inlet	gas outlet	TCC	PC	probe ø (mm)	probe L (mm)	cap. (mm)	probe type	pressure regulator (mbar)	gland nut	Ref. No.	
1	101431	13-38	1/2"	1/2"	M10x1	M10x1	8	120	1050	type E1	3-18	-	0710125
2	101910	20-90	1/2"	3/8"	M9x1	M10x1	10.5	19	1050	type F2	3-18	-	0710852
3	101432	30-90	1/2"	1/2"	M9x1	M10x1	8	100	1050	type E2	3-18	-	0710199
4	101130	30-100	1/2"	3/8"	M9x1	M10x1	5	122	1050	type A1	-	-	0710850
4	101131	50-190	1/2"	3/8"	M9x1	M10x1	5	98	1200	type A2	-	-	0710750
4	101135	110-190	1/2"	3/8"	M9x1	M10x1	6	102	1050	type A3	-	-	0710756
4	106984	110-190	1/2"	3/8"	M9x1	M10x1	6	102	1050	type A3	-	-	0710764
4	107237	70-210	1/2"	3/8"	M9x1	M10x1	4	122	1300	-	-	-	0710741
4	106931	70-310	1/2"	3/8"	M9x1	M10x1	4	72	1300	-	-	-	0710647
4	101435	100-340	1/2"	3/8"	M9x1	M10x1	4	72	1050	type C1	-	-	0710654
4	101132	100-340	1/2"	3/8"	M9x1	M10x1	5	68	1050	type B1	-	-	0710650
4	101134	100-340	1/2"	3/8"	M9x1	M10x1	5	68	1800	type B1	-	-	0710652

'probe thread 1/4"



fig.	temp. (°C)	gas inlet	gas outlet	TCC	PC	probe ø (mm)	probe L (mm)	cap. (mm)	probe type	pressure regulator (mbar)	gland nut	Ref. No.	
5	101088	30-100	1/2"	3/8"	M9x1	M10x1	5	125	1050	type A1	3-18	-	0710851
5	101437	110-190	1/2"	3/8"	M9x1	M10x1	6	102	1050	type A3	3-18	-	0710757
5	106239	100-340	1/2"	3/8"	M9x1	M10x1	4	72	1050	type C1	3-18	-	0710655
5	101438	100-340	1/2"	3/8"	M9x1	M10x1	5	68	1050	type B1	3-18	-	0710651
5	101965	100-340	1/2"	3/8"	M9x1	M10x1	5	68	1750	type B1	3-18	-	0710657

Table continues overleaf



fig.	temp. (°C)	gas inlet	gas outlet	TCC	PC	probe ø (mm)	probe L (mm)	cap. (mm)	probe type	pressure regulator (mbar)	gland nut	Ref. No.	
6	101689	40-110	1/2"	3/8"	M9x1	M10x1	5	125	1050	type A1	-	-	0710819
7	106030	40-110	1/2"	3/8"	M9x1	M10x1	5	125	1050	type A1	3-18	-	0710817
8	101912 <sup>1</sup>	50-190	1/2"	3/8"	M9x1	M10x1	14.4	14.5	1050	type F1	3-18	-	0710752
9	101434	110-190	1/2"	3/8"	M9x1	M10x1	5	102	1200	type G1	-	-	0710758

<sup>1</sup>probe thread 1/4"



fig.	temp. (°C)	gas inlet	gas outlet	TCC	PC	probe ø (mm)	probe L (mm)	cap. (mm)	probe type	pressure regulator (mbar)	gland nut	Ref. No.	
10	101114 <sup>1</sup>	110-190	1/2"	3/8"	M9x1	M10x1	10.5	26	1050	type F3	3-18	-	0710754
11	101678 <sup>1</sup>	110-190	1/2"	3/8"	M9x1	M10x1	10.5	26	1050	type F3	-	-	0710760
12	101385	60-200	3/8"	3/8"	M10x1	M10x1	5	95	1050	type D2	-	M14x1.5	0710724
13	106037 <sup>2</sup>	60-200	3/8"	3/8"	M10x1	M10x1	5	100	1150	type D2	3-18	M14x1.5	0710746

<sup>1</sup>probe thread 1/4" <sup>2</sup>gland box M14x1.5



fig.	temp. (°C)	gas inlet	gas outlet	TCC	PC	probe ø (mm)	probe L (mm)	cap. (mm)	probe type	pressure regulator (mbar)	gland nut	Ref. No.	
14	101133	60-200	1/2"	3/8"	M10x1	M10x1	5	95	1050	type D2	-	M14x1.5	—
15	106029	120-200	3/8"	3/8"	M9x1	M10x1	6	105	1050	type D1	-	M14x1.5	0710743
16	102872	120-340	3/8"	3/8"	M10x1	M10x1	5	68	1050	type B2	-	-	0710619
17	103133	120-340	1/2"	3/8"	M9x1	M10x1	4	72	1050	type C2	-	-	0710648



18

fig.	temp. (°C)	gas inlet	gas outlet	TCC	PC	probe ø (mm)	probe L (mm)	cap. (mm)	probe type	pressure regulator (mbar)	gland nut	Ref. No.
18 106018	120-340	1/2"	3/8"	M10x1	M10x1	5	68	1050	type B1	15-30	-	0710656

accessories

probes



fig.	probe type	temp. (°C)	probe ø (mm)	probe L (mm)	cap. (mm)	application	fig.	probe type	temp. (°C)	probe ø (mm)	probe L (mm)	cap. (mm)	application
1 102100	type A1	30-100	5	122	1050	bain marie	1 102118	type A3	110-190	6	102	1050	fryer
1 102103	type A2	60-200	5	98	1050	fryer	2 107238	type A4	50-190	4	120	1200	fryer



fig.	probe type	temp. (°C)	probe ø (mm)	probe L (mm)	cap. (mm)	application	fig.	probe type	temp. (°C)	probe ø (mm)	probe L (mm)	cap. (mm)	application
3 102102	type B1	100-340	5	68	1750	oven/grill	4 106225 <sup>1</sup>	type D1	120-200	6	102	1050	fryer
3 102107	type C1	100-340	4	72	1050	oven/grill	4 102844	type D2	60-200	5	98	1050	fryer
3 106226	type C2	140-380	4	72	1050	oven/grill	4 107599 <sup>2</sup>	type D3	120-200	6	102	1050	fryer

<sup>1</sup>gland box M14x1,5 <sup>2</sup>gland box 3/8"



fig.	probe type	temp. (°C)	probe ø (mm)	probe L (mm)	cap. (mm)	application	fig.	probe type	temp. (°C)	probe ø (mm)	probe L (mm)	cap. (mm)	application
5 102106	type E1	13-38	8	120	1050	heating oven	6 106223 <sup>1</sup>	type F2	20-90	11	19	1050	bain marie
5 102117	type E2	30-90	8	100	1050	bain marie	6 102104 <sup>1</sup>	type F3	110-190	11	26	1050	fryer

<sup>1</sup>probe thread 1/4"



fig.	probe type	temp. (°C)	probe ø (mm)	probe L (mm)	cap. (mm)	application
7 102105	type G1	110-200	6	102	1050	fryer

## gas connecting pieces

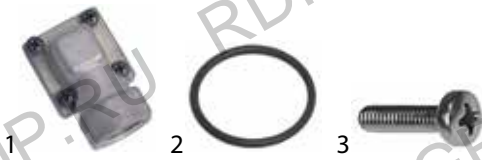

fig.		description
1	101505	gas connecting piece thread 3/8" angled without O-ring MINISIT 710
1	101268	gas connecting piece thread 3/8" angled with O-ring MINISIT 710
1	101269	gas connecting piece thread 1/2" angled with O-ring MINISIT 710
1	101504	gas connecting piece thread 1/2" angled without O-ring MINISIT 710
2	100809	O-ring EPDM thickness 2mm ID ø 21mm Qty 1 pcs
3	101517	flat-headed bolt thread M4 thread L 23mm
3	101516	flat-headed bolt thread M4 thread L 16mm SS DIN/ISO Qty 1 pcs

## minimum flow setting screws



pos.	ø (mm)	pos.	ø (mm)	pos.	ø (mm)	pos.	ø (mm)	pos.	ø (mm)	pos.	ø (mm)
1	102926	0	4	102928	0.8	7	102931	1.1	10	102933	1.3
2	102945	0.5	5	102929	0.85	8	102602	1.15	11	102934	1.6
3	102927	0.55	6	102930	1	9	102932	1.2	12	102935	1.9
									13	102936	2
									14	102937	2.1
									15	102938	2.2
									16	102939	2.5
									17	102940	2.8

## screw connections



fig.	description	fig.	description
1	101278 olive for pipe ø 10mm Qty 1 pcs	3	102505 locking screw M10x1 for pipe ø 6mm Qty 5 pcs
2	101279 union screw thread 3/8" for pipe ø 10mm Qty 1 pcs	3	101602 locking screw thread M10x1 for pipe ø 1/4"
1	101273 olive for pipe ø 12mm L 9,5mm brass Qty 1 pcs	4	101267 reducer IT 3/8" ET 1/2" L 21mm
2	101276 union screw thread 3/8" tube ø 12mm Qty 1 pcs	5	101271 screw connection IT 1/2" ET 3/8" L 25 mm
1	101274 olive for pipe ø 16mm Qty 1 pcs	6	101270 screw connection IT 3/8" ET 3/8" L 28 mm
2	101275 union screw thread 1/2" for pipe ø 16mm Qty 1 pcs	7	101272 screw connection IT 1/2" ET 3/8" L 57 mm
3	100904 locking screw M10x1 for pipe ø 4mm Qty 1 pcs	8	100820 gland duct ET M14x1.5 IT M10x0.75
3	100905 locking screw M10x1 for pipe ø 6mm Qty 1 pcs		

## miscellaneous



fig.	description	fig.	description
1	101053 magnet unit T1: M9x1 T2: M24x1 L 45 mm ø 17 mm	3	107517 piezoelectric igniter suitable for Minisit
1	101054 magnet unit T1: M10x1 T2: M24x1 L 45 mm ø 17 mm	4	101137 cover cap without piezoelectric igniter
2	107564 piezoelectric igniter body plastic blowing ø 22mm	5	101774 cover



MERTIK



fig.	temp. (°C)	GIB	GIL	GOB	GOL	TCC	PC	cap. (mm)	probe ø (mm)	probe L (mm)	CL (mm)	gland nut	Ref. No.	
1	106435	110-190	3/8"	3/8"	3/8"	3/8"	M9x1	M10x1	720	4	165	-	1/4"	GV30T-C5AJEAK0-001
1	106975	110-190	3/8"	3/8"	3/8"	3/8"	M9x1	M10x1	720	5	160	-	1/4"	GV30T-C5AYEAK0-002
1	106436	100-340	3/8"	3/8"	3/8"	3/8"	M9x1	M10x1	720	4	68	-	-	GV30T-C5AGEAK0-002
1	106434	30-110	3/8"	3/8"	3/8"	3/8"	M9x1	M10x1	720	6	78	-	-	GV30T-C5AKEAK0-002
2	106700	110-190	3/8"	3/8"	3/8"	3/8"	M9x1	M10x1	720	4	165	900	-	GV31T-C5AXE2K0-003
2	106397	100-340	3/8"	-	3/8"	-	M9x1	M10x1	720	4	68	1550	-	GV30T-C1A7AMK6E0
2	106813	100-340	3/8"	-	3/8"	-	M9x1	M10x1	720	4	68	1300	-	GV31T-C1A7AGK0-003
2	106814	100-340	3/8"	-	-	3/8"	M9x1	M10x1	720	4	68	900	-	GV30T-C3A7A2K0-002
3	107514	100-340	3/8"	3/8"	3/8"	3/8"	M8x1	M10x1	720	4	68	-	-	GV30T-C5A7E0D1
4	101744	100-340	3/8"	3/8"	3/8"	3/8"	M10x1	M10x1	730	4	66	1300	-	GV30T-C5A7AGC000



fig.	temp. (°C)	GIB	GIL	GOB	GOL	TCC	PC	cap. (mm)	probe ø (mm)	probe L (mm)	CL (mm)	gland nut	Ref. No.	
5	101855	100-340	3/8"	-	-	3/8"	M9x1	M10x1	720	4	68	900	-	GV30T-C3A7A2K0-013
5	101564	30-110	-	3/8"	-	3/8"	M9x1	M10x1	720	6	78	900	-	GV31T-C2AKA2K0E0

accessories



fig.	description	fig.	description
1	101273 olive for pipe ø 12mm L 9,5mm brass Qty 1 pcs	4	106718 union screw for gas thermostat MERTIK M9x1
2	101276 union screw thread 3/8" tube ø 12mm Qty 1 pcs	4	106719 union screw for gas thermostat MERTIK M10x1
3	106221 magnet unit L 32 mm D1 ø 19 mm D2 ø 14 mm	5	106702 plug 3/8" with O-ring L 12mm WS 8 brass

MP\_JUNKERS



fig.	temp. (°C)	gas inlet	gas outlet	TCC	probe ø (mm)	probe L (mm)	cap. (mm)	pressure controller	suitable for
1 101167	135-200	3/8" angled	3/8" straight	M10x1	6	220	920	-	Junkers Kroll Energy
2 101177	135-200	3/8" angled	3/8" straight	M10x1	6	220	920	X	Junkers
3 106024	170-300	3/8" straight	3/8" straight	M10x1	6	100	820	-	MKN

accessories



fig.	description	fig.	description
1 101273	olive for pipe ø 12mm L 9,5mm brass Qty 1 pcs	4 101060	magnet unit standard L 39 mm D1 ø 15,4 mm
2 101276	union screw thread 3/8" tube ø 12mm Qty 1 pcs	5 100039	piezoelectric igniter body plastic blowing
3 101040	magnet unit high temperature L 35 mm D1 ø 15,4 mm	6 102137	probe t.max. 200°C 135-200°C suitable for JUNKERS

PEL

24ST series



fig.	temp. (°C)	gas inlet	BN ø (mm)	gas outlet	TCC	probe ø (mm)	probe L (mm)	shaft ø (mm)	shaft L (mm)	shaft flat	suitable for
1 101078	55-110	M20x1.5 (tube ø 12mm)	0.35	M20x1.5 (tube ø 12/10mm)	M9x1	6	160	10x8	27/17	upper	Emmepi Gico MBM-Italia Olis
1 101077	110-220	M20x1.5 (tube ø 12mm)	0.35	M20x1.5 (tube ø 12/10mm)	M9x1	6	120	10x8	27/17	upper	—
1 106203	120-280	M20x1.5 (tube ø 12mm)	0.35	M20x1.5 (tube ø 12/10mm)	M9x1	6	120	10x9	27/17	upper	Nayati
1 101900	up to 280	M20x1.5 (tube ø 12mm)	0.8	M20x1.5 (tube ø 12/10mm)	M8x1	6	120	10x9	31/15	upper	Angelo-Po Thielmann
1 101433	100-300	M20x1.5 (tube ø 12mm)	0	M20x1.5 (tube ø 12/10mm)	M9x1	6	100	10x8	27/17	upper	—
1 106667	100-300	M20x1.5 (tube ø 12mm)	0.9	M20x1.5 (tube ø 12/10mm)	M9x1	6	100	10x8	27/17	upper	MBM-Italia

**technical data:**  
pilot connection M10x1  
capillary pipe length 1200mm

Table continues overleaf



**technical data:**  
pilot connection M10x1  
capillary pipe length 1200mm

fig.	temp. (°C)	gas inlet	BN ø (mm)	gas outlet	TCC	probe ø (mm)	probe L (mm)	shaft ø (mm)	shaft L (mm)	shaft flat	suitable for
1 101759	100-300	M20x1.5 (tube ø 12mm)	1.5	M20x1.5 (tube ø 12/10mm)	M9x1	6	100	10x8	27/17	upper	Lotus
1 101076	120-320	M20x1.5 (tube ø 12mm)	0.35	M20x1.5 (tube ø 12/10mm)	M9x1	6	100	10x8	27/17	upper	Ambach Bartscher Electrolux GIGA Ilsa Offcar Olis Rosinox Silko Star10
1 106192	140-340	M20x1.5 (tube ø 12mm)	0	M20x1.5 (tube ø 12/10mm)	M8x1	6	100	10x9	31/15	upper	—
2 106197	120-280	pipe flange ø21mm	0.35	M20x1.5 (tube ø 12/10mm)	M9x1	6	120	10x8	31/15	upper	Angelo-Po
2 106198	140-340	pipe flange ø21mm	0	M20x1.5 (tube ø 12/10mm)	M8x1	6	100	10x9	27/17	upper	Angelo-Po

24STS series



**technical data:**  
thermocouple connection M9x1  
pilot connection M10x1  
capillary pipe length 1200mm

fig.	temp. (°C)	gas inlet	BN ø (mm)	gas outlet	probe ø (mm)	probe L (mm)	shaft ø (mm)	shaft L (mm)	shaft flat	suitable for
1 106195	up to 210	flange	0	flange	6	120	10x8	27/17	upper	—
1 106026	100-300	flange	0	flange	6	100	10x8	27/17	upper	—
1 106382	110-310	flange	0	flange	6	100	10x8	27/17	upper	—
1 107228	110-310	flange	1.1	flange	6	100	10x8	27/17	upper	Charvet
1 101159	120-320	flange	0.35	flange	6	100	10x8	27/17	upper	Charvet Emmepi
1 106391	140-340	flange	0	flange	6	100	10x8	27/17	upper	—
1 106196	up to 350	flange	0	flange	6	100	10x8	27/17	upper	—
2 106027	100-300	M20x1.5 (tube ø 12/10mm)	0	M20x1.5 (tube ø 12/10mm)	6	100	10x8	27/17	upper	Küppersbusch Thielmann
3 107209	100-300	M20x1.5 (tube ø 12/10mm)	1.2	M20x1.5 (tube ø 12/10mm)	6	100	10x8	27/17	upper	MBM-Italia
3 101160 <sup>1</sup>	120-320	M20x1.5 (tube ø 12/10mm)	0.35	M20x1.5 (tube ø 12/10mm)	6	100	10x8	27/17	upper	Electrolux Zanussi

<sup>1</sup>incl. knob and connectors



**technical data:**  
thermocouple connection M9x1  
pilot connection M10x1  
capillary pipe length 1200mm

fig.	temp. (°C)	gas inlet	BN ø (mm)	gas outlet	probe ø (mm)	probe L (mm)	shaft ø (mm)	shaft L (mm)	shaft flat	suitable for
4 101161	120-320	M20x1.5 (tube ø 12/10mm)	0.35	M20x1.5 (tube ø 12/10mm)	6	100	10x8	27/17	upper	Angelo-Po Emmepi Iberital-Macchine

accessories

bypass nozzles



pos.	ø (mm)	pos.	ø (mm)	pos.	ø (mm)	pos.	ø (mm)	pos.	ø (mm)	pos.	ø (mm)						
1	106201	0	7	100493	0.7	13	100627	1	19	100666	1.3	25	100250	1.6	31	100267	1.9
2	100455	0.35	8	100494	0.75	14	100628	1.05	20	100667	1.35	26	100251	1.65	32	100268	1.95
3	106235	0.4	9	100497	0.8	15	100649	1.1	21	100674	1.4	27	100263	1.7	33	100273	2
4	100448	0.5	10	100546	0.85	16	100655	1.15	22	100677	1.45	28	100264	1.75	34	106393	2.75
5	100458	0.6	11	100597	0.9	17	100659	1.2	23	100679	1.5	29	100265	1.8			
6	100459	0.65	12	100598	0.95	18	100664	1.25	24	100699	1.55	30	100266	1.85			

miscellaneous



fig.	description	fig.	description
1	101246 olive for pipe ø 4mm Qty 1 pcs	5	101249 olive for pipe ø 10mm Qty 1 pcs
1	106741 olive for pipe ø 4mm Qty 10 pcs	6	101250 union nut M20x1,5 for pipe ø 10mm
2	100908 union screw thread M10x1 for pipe ø 4mm Qty 1 pcs	7	101248 olive for pipe ø 12mm Qty 1 pcs
2	102508 union screw thread M10x1 for pipe ø 4mm Qty 5 pcs	8	101251 union nut M20x1,5 for pipe ø 12mm
3	101286 olive ID ø 6mm Qty 1 pcs	9	101331 adapter for flanged cable 10/12mm
3	102586 olive ID ø 6mm Qty 10 pcs	10	101058 magnet unit L 39 mm D1 ø 15,4 mm D2 ø 13,5 mm
4	100909 union screw thread M10x1 for pipe ø 6mm Qty 1 pcs	11	106199 nut M8x1
4	102509 union screw thread M10x1 for pipe ø 6mm Qty 5 pcs	11	106200 nut M9x1 suitable for PEL 24/25S

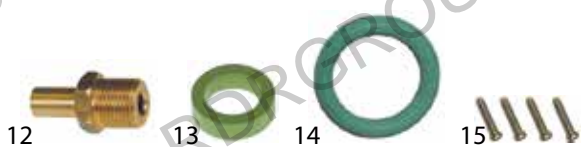

fig.	description	fig.	description
12	101239 adapter 3/8" ø 10mm left-hand thread	14	101460 O-ring suitable for PEL22 ø 12,37mm D1 ø 2,62mm
13	106165 gasket ø 27mm	15	101461 screw suitable for PEL22 kit Qty 4 pcs

25ST series



fig.	temp. (°C)	gas inlet	BN ø (mm)	gas outlet	TCC	probe ø (mm)	probe L (mm)	shaft ø (mm)	shaft L (mm)	shaft flat	suitable for	
1	101441	30-90	M16x1.5 (tube ø 10mm)	0.35	M16x1.5 (tube ø 10/8mm)	M9x1	6	160	8x6.5	21/15	upper	Mareno MBM-Italia Modular
1	107163	100-180	M16x1.5 (tube ø 10mm)	0.35	M16x1.5 (tube ø 10/8mm)	M9x1	6	195	8x6.5	21/15	upper	—
1	101442	100-200	M16x1.5 (tube ø 10mm)	0.35	M16x1.5 (tube ø 10/8mm)	M9x1	6	120	8x6.5	21/15	upper	—
1	101906	up to 250	M16x1.5 (tube ø 10mm)	1	M16x1.5 (tube ø 10/8mm)	M8x1	6	120	6x4.6	36/25	lower	Mareno
1	101907	up to 280	M16x1.5 (tube ø 10mm)	1	M16x1.5 (tube ø 10/8mm)	M8x1	6	120	6x4.6	36/20	lower	Mareno
1	107515	up to 280	M16x1.5 (tube ø 10mm)	1	M16x1.5 (tube ø 10/8mm)	M8x1	6	120	8x6.5	26/15	upper	Baron Mareno

**technical data:**  
pilot connection M10x1  
capillary pipe length 1200mm

Table continues overleaf



**technical data:**  
pilot connection M10x1  
capillary pipe length 1200mm

fig.	temp. (°C)	gas inlet	BN ø (mm)	gas outlet	TCC	probe ø (mm)	probe L (mm)	shaft ø (mm)	shaft L (mm)	shaft flat	suitable for
1 101991	100-300	M16x1.5 (tube ø 10mm)	0	M16x1.5 (tube ø 10/8mm)	M9x1	6	100	8x6.5	21/15	upper	Baron Solymac
1 101172	100-300	M16x1.5 (tube ø 10mm)	0.35	M16x1.5 (tube ø 10/8mm)	M9x1	6	100	8x6.5	21/15	upper	Bertos Gico Lotus MBM-Italia Modular Morice Offcar Öztiryakiler Tecnoinox
1 107593	100-300	M16x1.5 (tube ø 10mm)	0.9	M16x1.5 (tube ø 10mm)	M9x1	6	100	8x6.5	21/15	upper	Lincar
1 101955	140-300	M16x1.5 (tube ø 10mm)	0.5	M16x1.5 (tube ø 10/8mm)	M8x1	6	120	8x6.5	38/15	upper	Electrolux Whirlpool Zanussi
1 101719	30-110	M16x1.5 (tube ø 10mm)	0.35	M16x1.5 (tube ø 10/8mm)	M9x1	6	160	8x6.5	21/15	upper	—
1 107470	90-250	M16x1.5 (tube ø 10mm)	1	M16x1.5 (tube ø 10/8mm)	M8x1	6	120	8x6.5	26/15	upper	Baron Mareno
2 107459	up to 110	M16x1.5 (tube ø 10mm)	0	M16x1.5 (tube ø 10/8mm)	M9x1	6	160	8x6.5	21/15	upper	Olis
2 101332	120-320	M16x1.5 (tube ø 10mm)	0	M16x1.5 (tube ø 10/8mm)	M9x1	6	100	8x6.5	21/15	upper	Jemi
3 101905	100-200	pipe flange ø21mm	0.35	M16x1.5 (tube ø 10/8mm)	M9x1	6	120	8x6.5	21/15	upper	Ascobloc
3 101565	up to 280	pipe flange ø21mm	0	M16x1.5 (tube ø 10/8mm)	M9x1	6	122	8x6.5	21/15	upper	Angelo-Po
3 106658	up to 280	pipe flange ø21mm	0.8	M16x1.5 (tube ø 10/8mm)	M9x1	6	120	8x6.5	45x22		Lincat
3 106987	100-300	pipe flange ø21mm	0.95	M16x1.5 (tube ø 10/8mm)	M9x1	6	100	8x6.5	26/15	upper	MBM-Italia
3 101901	50-300	pipe flange ø21mm	0.35	M16x1.5 (tube ø 10/8mm)	M9x1	6	100	8x6.5	21/15	upper	Ascobloc Offcar

accessories

bypass nozzles



pos.	ø (mm)	pos.	ø (mm)	pos.	ø (mm)	pos.	ø (mm)	pos.	ø (mm)	pos.	ø (mm)
1 106191	0	5 100390	0.5	9 100429	0.7	13 100433	0.9	17 100436	1.1	21 100413	1.65
2 100259	0.35	6 100391	0.55	10 100432	0.75	14 100434	0.95	18 100437	1.15	22 100776	1.75
3 100281	0.4	7 100392	0.6	11 100409	0.8	15 100407	1	19 100438	1.2	23 106656	1.8
4 100414	0.45	8 100428	0.65	12 100410	0.85	16 100435	1.05	20 106499	1.3		

miscellaneous



fig.	description	fig.	description
1 101246	olive for pipe ø 4mm Qty 1 pcs	4 100909	union screw thread M10x1 for pipe ø 6mm Qty 1 pcs
1 106741	olive for pipe ø 4mm Qty 10 pcs	4 102509	union screw thread M10x1 for pipe ø 6mm Qty 5 pcs
2 100908	union screw thread M10x1 for pipe ø 4mm Qty 1 pcs	5 101450	olive for pipe ø 8mm L 12,7mm Qty 1 pcs ED ø 10mm
2 102508	union screw thread M10x1 for pipe ø 4mm Qty 5 pcs	6 101451	union nut M16x1,5 tube ø 8mm
3 101286	olive ID ø 6mm Qty 1 pcs	7 101278	olive for pipe ø 10mm Qty 1 pcs
3 102586	olive ID ø 6mm Qty 10 pcs		

Table continues overleaf



fig.	description
8	101300 union nut M16x1,5 tube ø 10mm
9	101040 magnet unit high temperature L 35 mm D1 ø 15,4 mm
10	106199 nut M8x1

fig.	description
10	106200 nut M9x1 suitable for PEL 24/25S
11	101880 gasket Viton D1 ø 14mm D2 ø 9mm thickness 7,7mm

AB



**technical data:**  
 capillary pipe length 36"- 915mm  
 probe diameter 5,3mm  
 probe length 138mm

fig.	type	temp. (°C)	gas inlet	gas outlet	TCC	PC	shaft ø (mm)	shaft L (mm)	shaft flat	suitable for	
1	107915	A65T	100-300	M16x1.5 (tube ø 10mm)	M16x1.5 (tube ø 10/8mm)	M9x1	M10x1	8x6,15	26/15	lower	Öztiryakiler

COPRECI

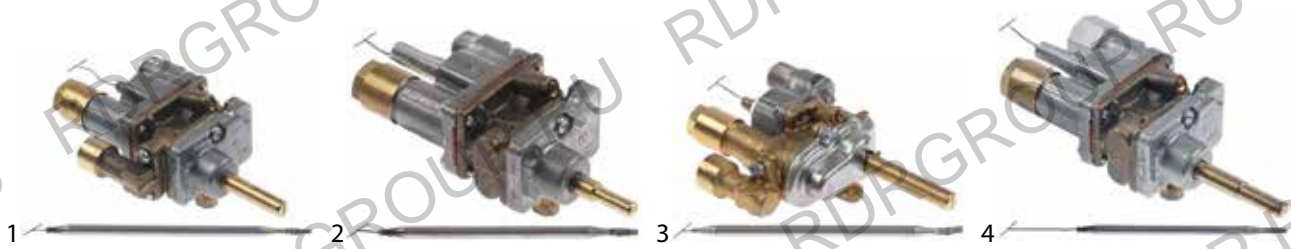

fig.	gas inlet	BN ø (mm)	gas outlet	PC	TCC	cap. (mm)	probe ø (mm)	probe L (mm)	shaft ø (mm)	shaft L (mm)	shaft flat	suitable for	
1	101533	pipe flange ø21mm	0.35	3/8"	1/8"	M8x1	1000	6	135	8x6.5	33/12	right	Fagor
1	109534	pipe flange ø21mm	0.5	3/8"	closed	M8x1	1100	4	82	8x6.5	33/12	right	Fagor
1	109051	pipe flange ø21mm	0.6	3/8"	1/8"	M8x1	1100	4	84	8x6.5	33/12	right	Fagor
2	109089	pipe flange ø21mm	0.45	M14x1.5	-	M8x1	840	4.5	92	6x4.6	27/14	lower	Ambassade Öztiryakiler
3	109112	pipe flange ø21mm	0.5	M14x1.5	1/8"	M8x1	850	6	130	8x6.5	42/12	right	Fagor
4	109129	pipe flange ø21mm	0.6+0.44	M16x1.5 (tube ø 10mm)	closed	M8x1	1000	4.5	92	7x5	41.5/20	lower	Falcon
4	109130	pipe flange ø21mm	0.76+0.52	M16x1.5 (tube ø 10mm)	closed	M8x1	1000	4.5	92	7x5	41.5/20	right	Falcon

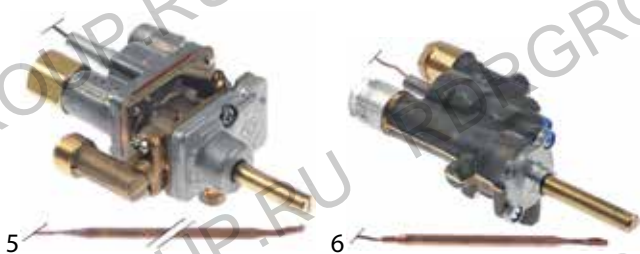

fig.	gas inlet	BN ø (mm)	gas outlet	PC	TCC	cap. (mm)	probe ø (mm)	probe L (mm)	shaft ø (mm)	shaft L (mm)	shaft flat	suitable for	
5	109050	pipe flange ø21mm	0.64	3/8"	1/8"	2x M8x1	1000	5	110	8x6.5	33/12	right	Fagor
6	109160	pipe flange ø21mm	0.95	M15x1 (tube ø 10mm)	-	M8x1	1200	5	97	8x6	41/20	lower	Falcon



accessories



fig.	description	fig.	description
1	101538 clip	3	101376 gasket ID ø 8mm ED ø 12mm H 3/5mm
2	101537 gasket ID ø 8mm ED ø 11,5mm H 3mm Qty 1 pcs	4	101040 magnet unit high temperature L 35 mm D1 ø 15,4 mm
2	107431 gasket set ID ø 8mm ED ø 11,5mm H 3mm Qty 7 pcs	5	101060 magnet unit standard L 39 mm D1 ø 15,4 mm

**SABAF**



fig.	t.max. (°C)	gas inlet	BN ø (mm)	gas outlet	TCC	cap. (mm)	probe ø (mm)	probe L (mm)	shaft ø (mm)	shaft L (mm)	shaft flat	suitable for	
1	101173	300	M13x1 ET (tube ø 8mm)	0.8	3/8" ET (tube ø 10mm)	M8x1	850	4	140	6x4.6	37/15	lower	Cookmax Mareno
1	101692	300	M13x1 IT (tube ø 8mm)	0.5	3/8" ET (tube ø 10mm)	M8x1	850	4	140	8x6.5	34/14	upper	Modular Multi
2	101687	300	pipe flange ø16mm	0.37	M13x1 IT (tube ø 8mm)	M8x1	850	4	140	8x6.5	17/12	lower	Faba Fimar Simogas
2	101886	300	pipe flange ø16mm	0.37	M13x1 IT (tube ø 8mm)	M8x1	850	4	140	8x6.5	17/12	upper	Anitec MBM-Italia Star10
2	101181	300	pipe flange ø16mm	0.46	M13x1 IT (tube ø 8mm)	M8x1	850	4	150	6x4.6	45/27	upper	Bertos GIGA Star10
2	106742	300	pipe flange ø16mm	0.52	M13x1 IT (tube ø 8mm)	M8x1	850	4	150	6x4.6	45/27	upper	Bertos
3	101836	300	pipe flange ø21mm	0.45	3/8" ET (tube ø 10mm)	2x M8x1	850	4	140	8x6.5	35/14	left	Lotus
3	107150	300	pipe flange ø21mm	0.5	3/8" ET (tube ø 10mm)	2x M8x1	850	4	140	8x6.5	35/14	left	Lotus

\*with microswitch and additional gas outlet M13x1 IT (tube ø 8mm)

accessories



fig.	description	fig.	description
1	101277 olive ID ø 8mm Qty 1 pcs	4	101478 union nut 3/8" for pipe ø 10mm
2	101477 union screw M13x1 tube ø 8mm Qty 1 pcs	5	101376 gasket ID ø 8mm ED ø 12mm H 3/5mm
3	101476 union nut M13x1 for pipe ø 8mm	6	101351 mounting strap for gas tap
1	101278 olive for pipe ø 10mm Qty 1 pcs	7	101751 bracket

gas thermostats

ROBERTSHAW



fig.	type	temp. (°F)	gas inlet	gas outlet	cap. (mm)	probe ø (mm)	probe L (mm)	gland nut	suitable for
1	580062	200-550	flange (tube ø 5/16")	3/8" NPT	48" - 1220	3/16" - 4.7	11 1/4" - 285		Charvet Corsair Robertshaw Rosinox
2	106371	200-550	flange (tube ø 5/16")	1/4" NPT	48" - 1220	3/16" - 4.7	11 1/4" - 285	-	Imperial-USA Robertshaw
3	106657	150-400	flange (tube ø 5/16")	2x 1/4" NPT	24" - 610	3/16" - 4.7	7 3/4" - 195		Imperial-USA Robertshaw
4	580180	150-550	1/2" NPT	1/2" NPT	48" - 1220	3/16" - 4.7	14 3/4" - 375mm	-	Franklin Chef Garland Southbend

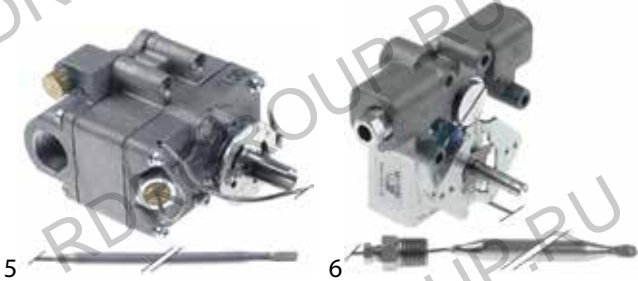

fig.	type	temp. (°F)	gas inlet	gas outlet	cap. (mm)	probe ø (mm)	probe L (mm)	gland nut	suitable for
5	580057	low-550	1/2" NPT	1/2" NPT	1380	5	365		Falcon Robertshaw
6	580041 <sup>1</sup>	200-400	1/4" CCT (tube ø 1/4")	1/4" CCT (tube ø 1/4")	30" - 760	3/8" - 9.5	5 3/8" - 135	1/4" NPT	Pitco Robertshaw Southbend
6	580051 <sup>1</sup>	200-375	1/4" CCT (tube ø 1/4")	1/4" CCT (tube ø 1/4")	18" - 455	1/4" - 6.35	12" - 305	1/4" NPT	Robertshaw
6	107562 <sup>1</sup>	200-393	1/4" CCT (tube ø 1/4")	1/4" CCT (tube ø 1/4")	30" - 760	3/8" - 9.5	5 3/8" - 135	1/4" NPT	Nayati Robertshaw
6	580052 <sup>2</sup>	200-375	1/4" CCT (tube ø 1/4")	1/4" CCT (tube ø 1/4")	24" - 610	3/8" - 9.5	5 3/8" - 135	3/8" NPT	Falcon Pitco Robertshaw

<sup>1</sup>with gland nut 1/4" NPT <sup>2</sup>with gland box 3/8" NPT

accessories



fig.	description	fig.	description
1	101481 olive for pipe ø 1/4" CCT Qty 1 pcs	3	106111 locking screw thread 7/16"-24 UNS for pipe ø 1/4"
2	106110 union screw tube ø 1/4"mm	4	101263 thermocouple screw connection ASA 11/32 Qty 1 pcs
3	106109 locking screw thread 7/16"-24 UNS for pipe ø 1/4"	5	106659 gas connecting piece suitable for thermostat



**TEDDINGTON**

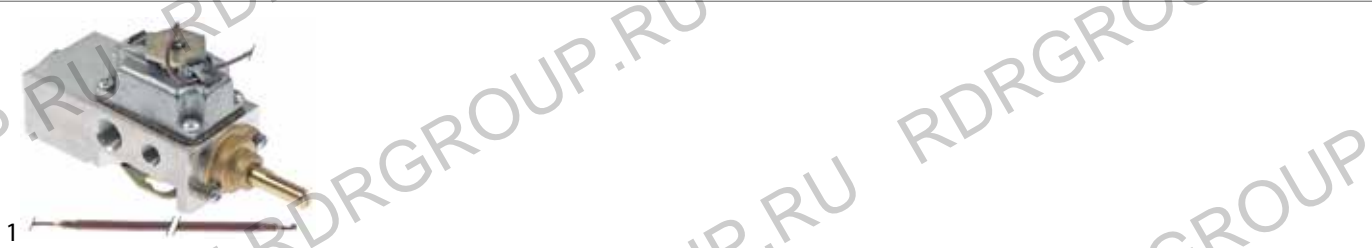

fig.	t.max. (°C)	gas inlet	BN ø (mm)	gas outlet (mm)	TCC	PC	cap. (mm)	probe ø (mm)	probe L (mm)	shaft ø (mm)	shaft L (mm)	shaft flat	suitable for
1 106372	260	flange (tube ø7.5mm)	1.3	1/4" NPT	ASA 11/32	1/8"	1100	4.8	198	8.8x6.3	28/19	lower	Imperial-USA

**STN3R**



pos.	t.max. (°C)	gas inlet	gas outlet	probe ø (mm)	probe L (mm)	cap. (mm)	suitable for	pos.	t.max. (°C)	gas inlet	gas outlet	probe ø (mm)	probe L (mm)	cap. (mm)	suitable for
1 106207	110	1/2"	1/2"	6.5	200	1200	—	3 106209	300	1/2"	1/2"	6.5	80	1200	Capic Charvet
2 106208	200	1/2"	1/2"	6.5	140	1200	Capic Charvet	4 106210	450	1/2"	1/2"	6.5	250	1200	Capic

gas thermostats